

6 PIER POINT - MARINE WALK
 SUNDERLAND - SR6 0PP
 T +44 (0)191 563 7025 F +44 (0)191 510 1746
 WWW.FITZARCHITECTS.CO.UK
 OFFICE@FITZARCHITECTS.CO.UK

CLIENT
 GLENROSE DEVELOPMENTS

PROJECT
 PROPOSED RESIDENTIAL DEVELOPMENT
 AT SHORTS OF WHITBURN

STAGE
 FEASIBILITY

DRAWING
 LEVEL 02 PLAN
 DWELLINGS 8-9

PROJECT NUMBER
 1342

SCALES
 1:50 @ A3

DRAWING NUMBER
 AL (00) 1500

DATE
 JAN 16

DRAWN BY
 CM

CHECKED BY
 CRF

REVISION

NORTH

REVISION	DATE AND DESCRIPTION

COPYRIGHT OF FITZ ARCHITECTS LIMITED
 NOT TO BE SCALED - ALL DIMENSIONS TO BE CHECKED ON SITE

50MM

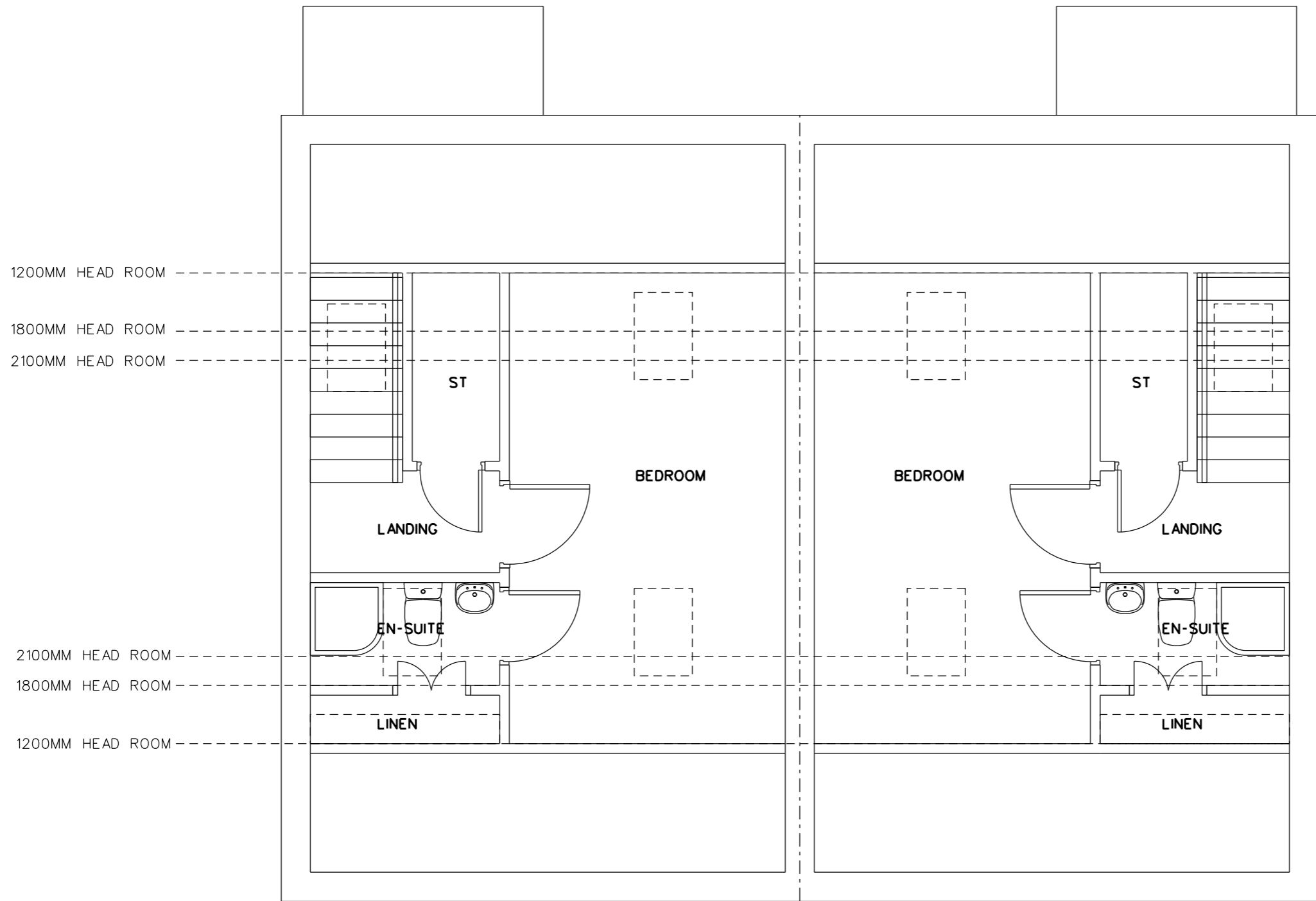

1200MM HEAD ROOM

1800MM HEAD ROOM

2100MM HEAD ROOM

2100MM HEAD ROOM

1800MM HEAD ROOM

1200MM HEAD ROOM